

Pin Header

Single Row/Dual Row

Straight DIP Type/Right Angle DIP Type

Pitch:1.27mm

Series

331 ~ 333

335 ~ 339

sgdconn

[Http://www.sgdconn.com](http://www.sgdconn.com)

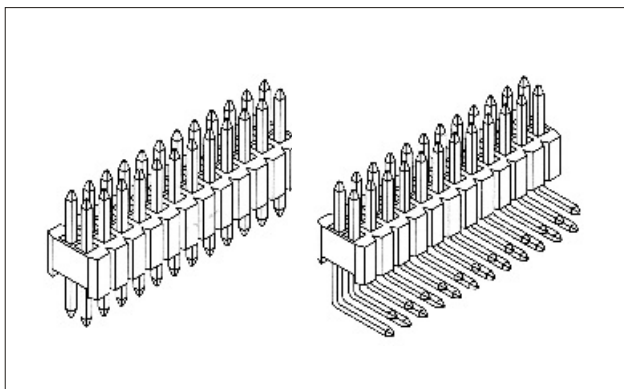

SPECIFICATIONS:

Current Rating: 1.0 AMP

Contact Resistance: 30m \bullet Max

Insulation Resistance: 1000M \bullet Min

Withstand Voltage: 300VAC/minute

Operation Temperature: -40 $^{\circ}$ C to +105 $^{\circ}$ C

MATERIALS:

Contact Material: Copper Alloy

Contact Plating: Gold or Tin over 50 μ "Ni

Insulator Material: Polyester(UL94V-0)

Standard: PA6T

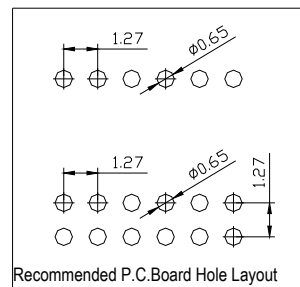
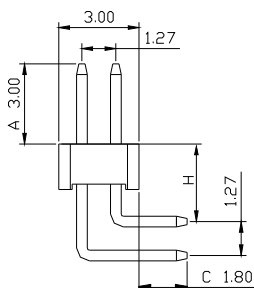
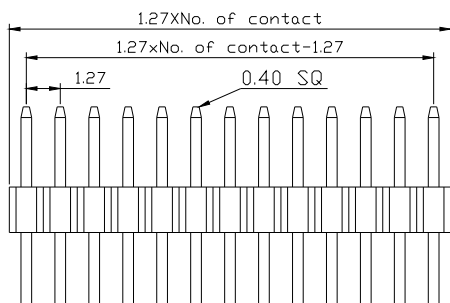
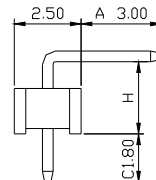
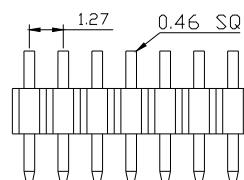
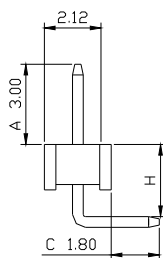
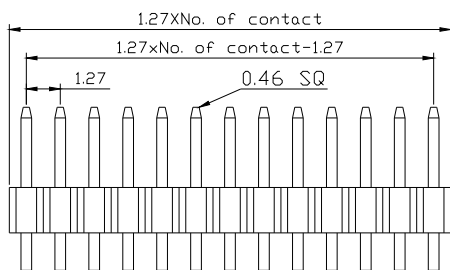
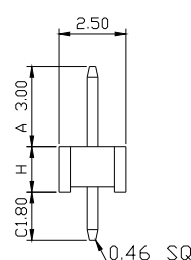
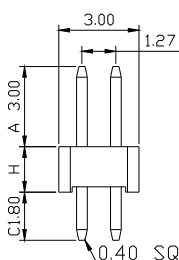
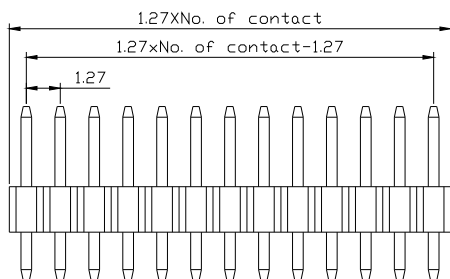

Ordering Code

① ② ③ ④ ⑤ ⑥ ⑦ ⑧ ⑨ ⑩
3 3 X X XX X 1 4 1 XXX

① Series No.:
3= Pin Header

② Pitch: 3 = 1.27mm

③ Insulator Height:
1 = 1.00mm 2 = 2.00mm
3 = 2.50mm 5 = 1.50mm
6 = 1.60mm 7 = 1.70mm
8 = 0.80mm 9 = 0.65mm

④ Dip Spacing:
1=Single row
2=Double row

⑤ Number of Contacts:
Single row = 01 to 50
Double row= 02 to 100

⑥ Tail & Mounting Style:
S=Straight DIP Type
R=Right Angle DIP Type

⑦ Contact Plated
0=Tin
1=Gold Flash
2=Gold 3u"
3=Gold 5u"
4=Gold 10u"
5=Gold 15u"
6= Gold 30u"

⑩ Pin Length
XXX=A+H+C

⑧ Material Type
2=LCP
3=Nylon-66
4=Nylon-6T
5=PA46

⑨ Tiers of Body
1 = Single tier
2 = Double tier
3 = Triple tier

Due to technical progress, all the information provided is subject to change without prior notice.