

Pitch: 2.54mm

Single Row /Dual Row

Straight DIP Type/Right Angle DIP Type

Series
311-313

sgdconn

[Http://www.sgdconn.com](http://www.sgdconn.com)

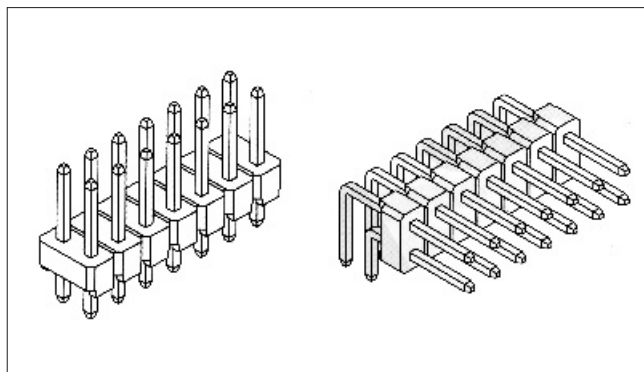

SPECIFICATIONS:

Current Rating: 3.0 AMP

Contact Resistance: 30m• Max

Insulation Resistance: 1000M• Min

Withstand Voltage: 600VAC/minute

Operation Temperature: -40°C to +105°C

MATERIALS:

Contact Material: Copper Alloy

Contact Plating: Gold or Tin over 50 μ " Ni

Insulator Material: Polyester(UL94V-0)

Standard: PA6T

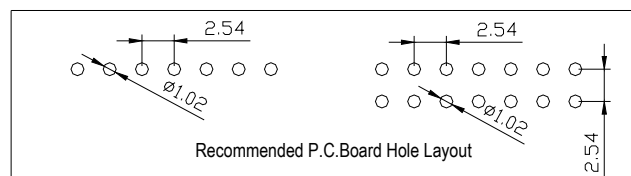
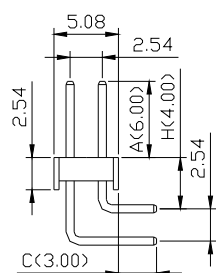
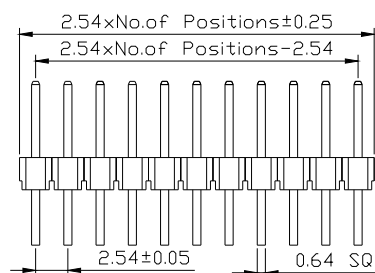
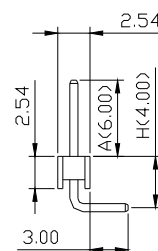
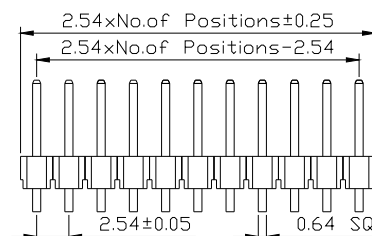
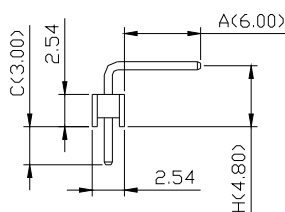
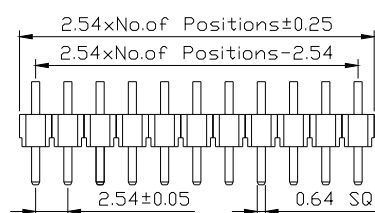
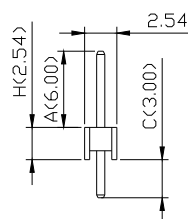
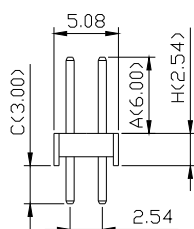
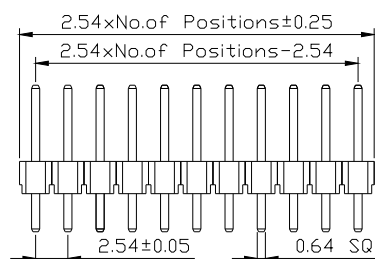

Ordering Code

① ② ③ ④ ⑤ ⑥ ⑦ ⑧ ⑨ ⑩
3 1 X X XX X 1 4 1 XXX

① Series No.:
3= Pin Header

② Pitch: 1 = 2.54mm

③ Insulator Height:
1 = 1.50mm
2 = 2.00mm
3 = 2.50mm

④ Dip Spacing:
1=Single row
2=Double row

⑤ Number of Contacts:
Single row = 01 to 40
Double row = 02 to 80

⑥ Tail & Mounting Style:
S=Straight DIP Type
R=Right Angle DIP Type

⑦ Contact Plated
0= Tin 1= Gold F lash
2= Gold 3u" 3= Gold 5u"
4= Gold 10u" 5= Gold 15u"
6= Gold 30u"

⑧ Material Type
0=PPS 3=Nylon-66
1=PBT 4=Nylon-6T
2=LCP 5=P A46

⑨ Tiers of Body
1 = Single tier
2 = Double tier
3 = Triple tier

⑩ Pin Length
XXX=A+H+C

Due to technical progress, all the information provided is subject to change without prior notice.